

QELC-K-3

2.92mm, DC~40GHz

Features:

- * Low VSWR
- * No welding
- * Reusable
- * Easy installation

Applications:

- * Laboratory Test

Electrical

Frequency: DC~40GHz
 VSWR: 1.25 max.
 Impedance: 50Ω

Mechanical

RF Connector: 2.92mm
 Outer Conductor: Passivated stainless steel
 Dielectric: PEI & PTFE
 Inner Conductor: Gold plated beryllium copper

Environmental

Temperature: -55~+165°C

How To Order

QELC-K-3 - Outline A

QELC-KF-3 - Outline B

Customization is available upon request.

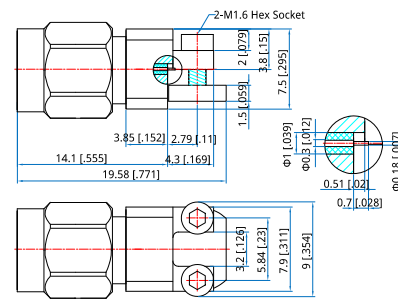
Outline Drawings

Outline A

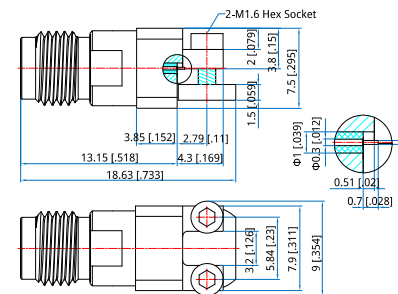

Outline B

Unit: mm [in]

Tolerance: ±0.2mm [±0.008in]